

A112-E-111

A112-E-112

1 D1/D2

A2

2

5 1 NS1402 INCOLOY ALLOY 825

3

1 A112-E-111

A112-E-112

2

3

### 3.1

1	A112-E-111	1	A112-E-111 B*U H-BU750-2.7/0.3573.9-2.3/192I 0.35MPa 0.006MPa 225 126/174 2.7MPa 1.752MPa 400 : 208/208 NS1402



3.2.9

3.2.10 A112-E-111

A112-E-112

2

3.2.11

3.2

18

12

1		2C+1E	
2		2C+1E	
3		2C+1E	
4		2C+1E	
5		2C+1E	
6		2C+1E	
C— E—pdf			

A112-E-111

150

A112-E-112

100

5.1

5.2

5.3

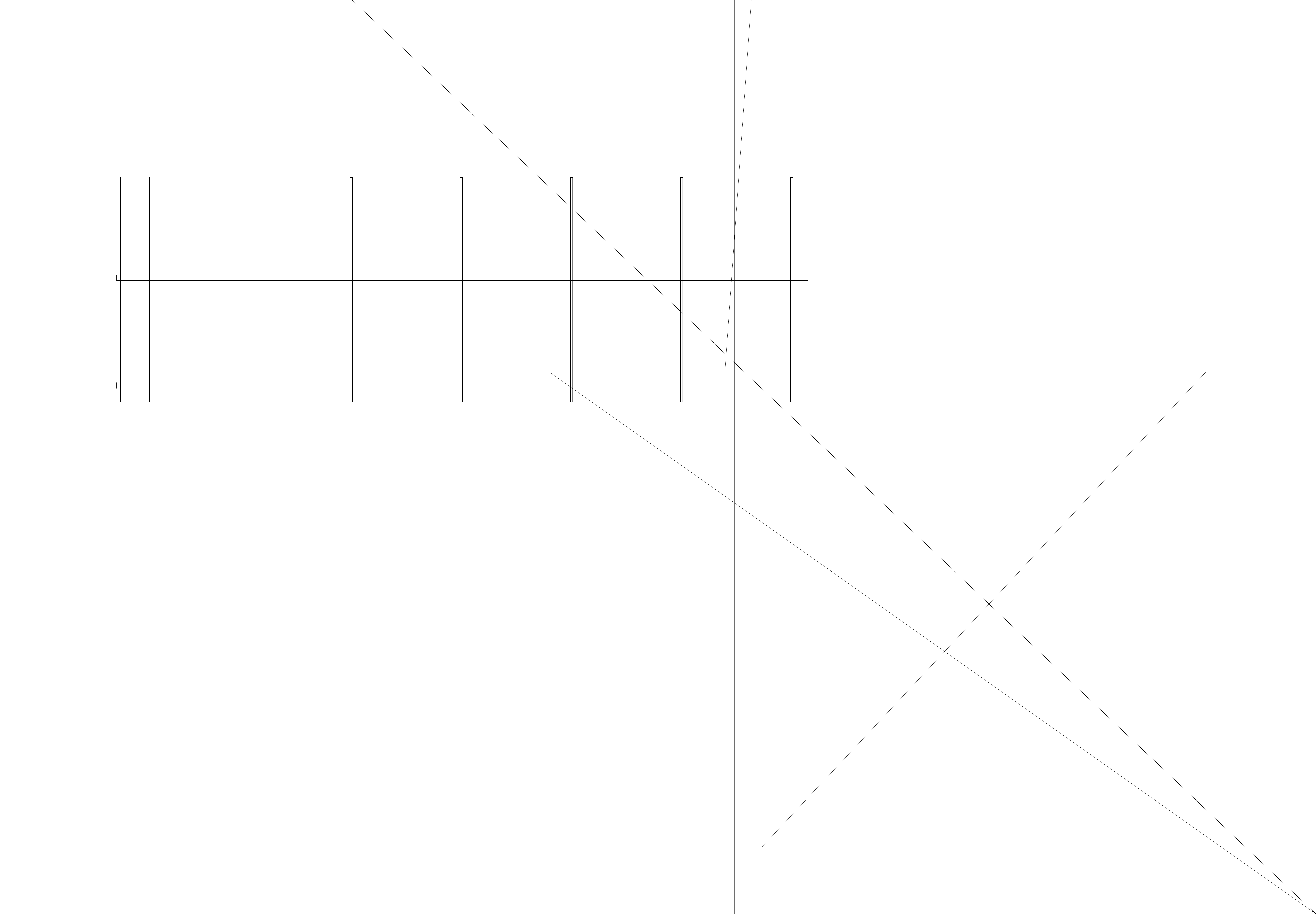

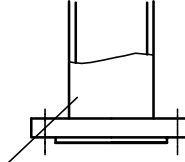
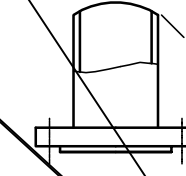

1-6

注: 1. 弯管部分包括直管段300mm范围内弯管

2. 管子采用1级管, 执行标准为GB/T30059-2013, U形管应按GB/T151-2014《热交换





1

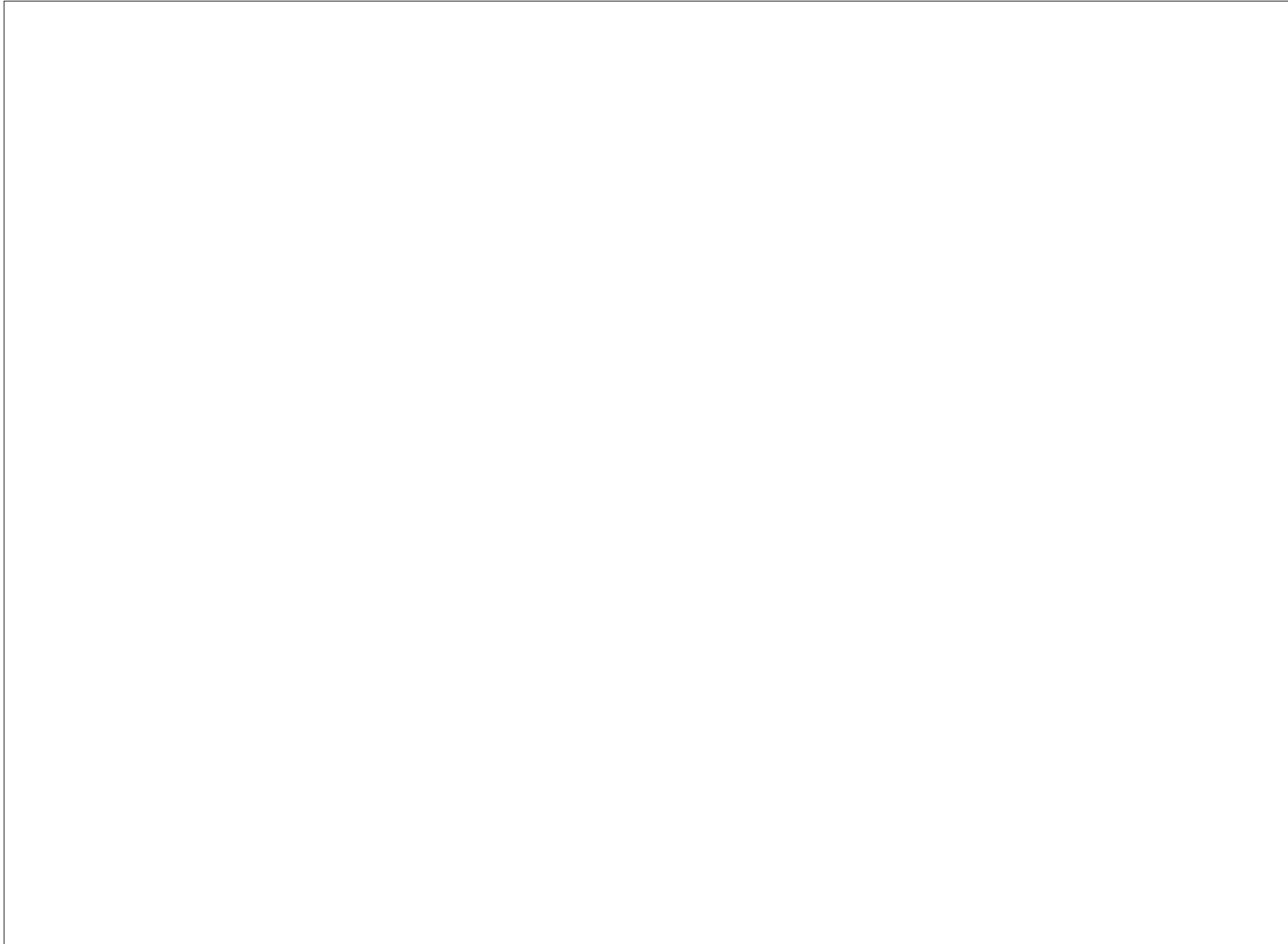

10#

11#

12#

13#

重量 k  
单重: 5745 kg

